

The Essex County Council (Tendring District) (Prohibition of Waiting, Loading and Stopping) and (On-Street Parking Places) (Civil Enforcement Area) (Amendment No. 25) Experimental Order 2022

Notice is hereby given Colchester Borough Council acting on behalf of the North Essex Parking Partnership in exercise of the delegated powers of the traffic authority Essex County Council granted under an Agreement dated 31 March 2011 has made an Order under Sections 9 and 10 and Parts III and IV of Schedule 9 to the Road Traffic Regulation Act 1984.

The effect of the Order: To revoke existing restrictions on Old Ipswich Road, Crown Lane North and on the Access Road to The Beeches, The Cedars and The Oaks on an experimental basis; to introduce No Stopping At Any Time and to introduce Limited Waiting For Cars only 6 hours no return within 1 hour on Old Ipswich Road.

This Order will be incorporated on an experimental basis into The Essex County Council (Tendring District) (Prohibition of Waiting, Loading and Stopping) and (On-Street Parking Places) (Civil Enforcement Area) Consolidation Order 2019 by replacing tile number TM020 292 with revision 1, TM020 290 with revision 1 and TM020 287 with revision 1.

Date of operation: The Order will come into effect on 9th May and may last up to 18 months. Any alterations to this Order which will render it less restrictive may be authorised by the Parking Partnership Group Manager without the requirement to re-advertise the Order under Section 10(2) of the said Act, and after consultation with the Chief Officer of Police.

Further details: The Order and other documents giving more detailed particulars of the Orders can be viewed at <https://nepp.essexworkstraffweb.org.uk/main.html> or <https://north.parkingpartnership.org/ardleigh-etro> or at Colchester Library, Trinity Square, CO1 1JB

Objections: The Council will consider in due course whether the provisions of the experimental order should be continued in force indefinitely. Within a period of six months beginning from the date on which the experimental order came into force, or if that order is varied by another order or modified pursuant to Section 10(2) of the 1984 Act, beginning with the day on which the variation or modification or the latest variation or modification came into force, any person may object to the making of an order for the purpose of such indefinite continuation. Any such objections must be sent to [\[https://nepp.essexworkstraffweb.org.uk/consult/main.html\]](https://nepp.essexworkstraffweb.org.uk/consult/main.html) or to TRO Comments, North Essex Parking Partnership, PO Box 5575, Colchester, CO1 9LT by 10th November 2022.

Application to the high court: Anyone who wishes to question the validity of the Order of any provision contained in it on the grounds that it is not within the powers conferred by the Road Traffic Regulation Act 1984 or on the grounds that any requirement of the Act, or any instrument made under it, has not been complied with in relation to the Order, may within six weeks from the date of the making of the Order apply to the High Court for this purpose.

Date: 5th May 2022

Richard Walker, Parking Partnership Group Manager, Colchester Borough Council,
Rowan House, 33 Sheepen Road, Colchester, CO3 3WG

The Essex County Council (Tendring District) (Prohibition of Waiting, Loading and Stopping) and (On-Street Parking Places) (Civil Enforcement Area) (Amendment No. 25) Experimental Order 2022

WHEREAS the Colchester Borough Council acting on behalf of the North Essex Parking Partnership in exercise of the delegated powers of the traffic authority Essex County Council granted under an Agreement dated 31 March 2011 hereby makes the above Order under Sections 1(1), 2(1) to (3), 4(1), 4(2), 32, 35, 45, 46, 49 and 53 of and Part IV of Schedule 9 to the Road Traffic Regulation Act 1984 (“the Act”) and of all other enabling powers and after consultation with the Chief Officer of Police in accordance with Part III of Schedule 9 to the Act:-

1. The Essex County Council (Tendring District) (Prohibition of Waiting, Loading and Stopping) and (On-Street Parking Places) (Civil Enforcement Area) (Amendment No. 25) Experimental Order 2022 and shall come into operation on 9th May 2022.

2. This Order will be incorporated into The Essex County Council (Tendring District) (Prohibition of Waiting, Loading and Stopping) and (On-Street Parking Places) (Civil Enforcement Area) Consolidation Order 2019 ‘the 2019 Order’ by:

a. Replacing the following Map Tiles:

TM020 292	revision 0 replaced by	TM020 292	revision 1
TM020 290	revision 0 replaced by	TM020 290	revision 1
TM020 287	revision 0 replaced by	TM020 287	revision 1

3. The Map Schedule Legend to this Order only applies to the Map Tiles listed in this Order.

4. The prohibitions and restrictions imposed by this Order shall be in addition to and not in derogation from any restrictions or requirement imposed by regulations made or having effect as if made under the Act or by any other enactment.

Sealed with the Common Seal of the Colchester Borough Council this Twenty Ninth day of April Two Thousand and Twenty-Two.

THE COMMON SEAL OF COLCHESTER)
BOROUGH COUNCIL was hereunto)
affixed in the presence of:-)

Authorised Signatory

The Essex County Council (Tendring District) (Prohibition of Waiting, Loading and Stopping) and (On-Street Parking Places) (Civil Enforcement Area) (Amendment No. 25) Experimental Order 2022

Statement of Reasons

Following the North Essex Parking Partnership being made aware of local concerns about parking issues, a no stopping at any time restriction is being introduced under an experimental order on Old Ipswich Road. The no stopping at any time restriction will prevent parking and so ensure sight lines remain clear and for avoiding danger to persons or other traffic using the road or any other road or for preventing the likelihood of any such danger arising and for facilitating the passage of any class of traffic.

Limited waiting bays are being introduced on two areas of Old Ipswich Road. These will allow the opportunity to park for up to 6 hours with no return within 1 hour for any motorists who need to visit properties on or near Old Ipswich Road.

The experimental order will allow the impact of the scheme to be monitored over the initial 6 month period, to work with local stakeholders and other road users to consider amendments to the scheme where appropriate.

The North Essex Parking Partnership intends to consider making a permanent order which has the same effect as the experimental order.

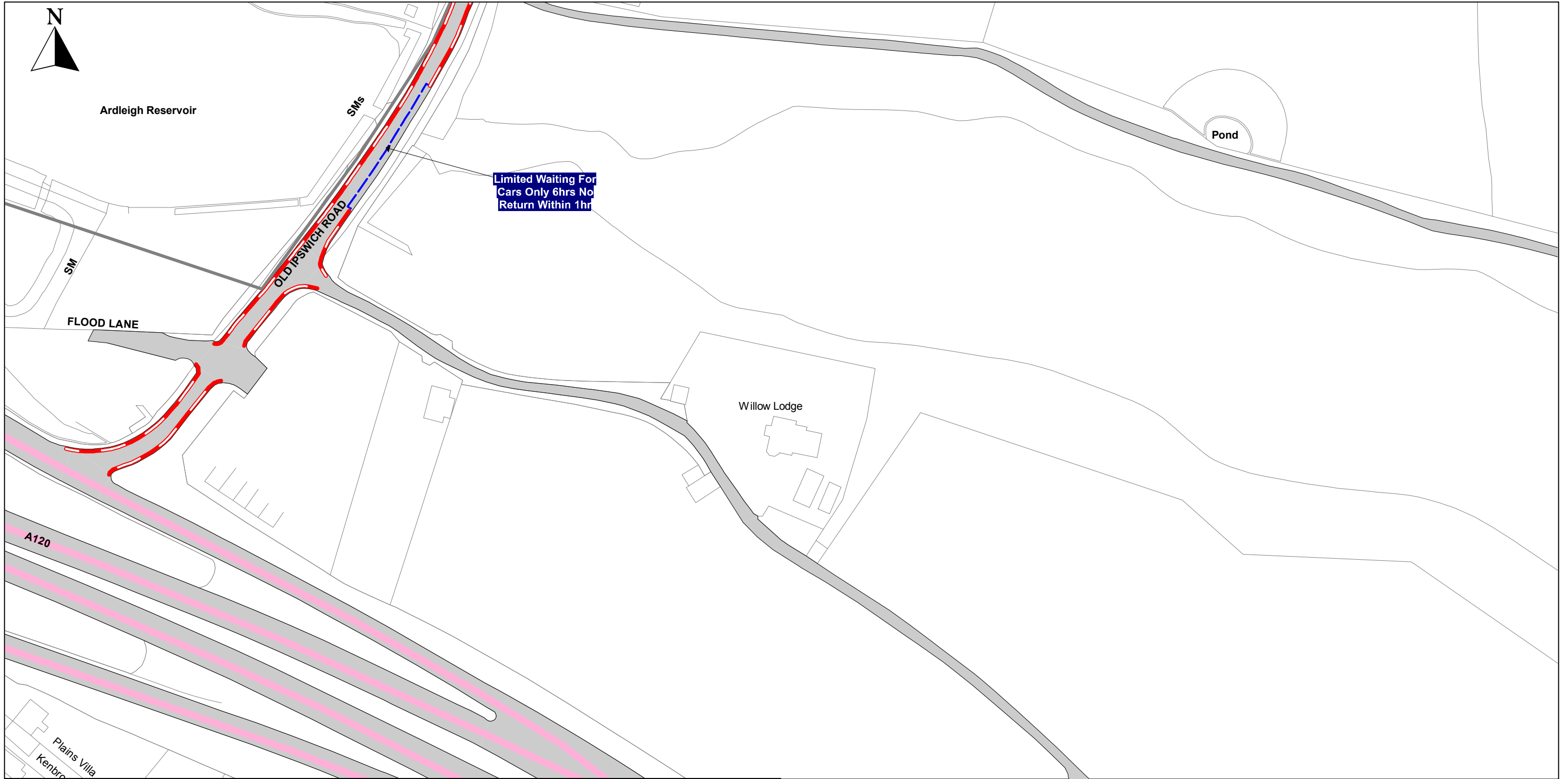

SEE STATIC MAP SCHEDULE LEGEND FOR RESTRICTIONS DISPLAYED

PROPOSED

Scale - 1 : 1250 @ A3



Title - Essex County Council On-Street Waiting, Loading and Parking Plans

Produced from Ordnance Survey 1:1250 mapping with permission of the Controller of Her Majesty's Stationary Office (c) Crown Copyright Licence No. 100019602
 Unauthorised reproduction infringes Crown Copyright and may lead to prosecution or Civil Proceedings

This copy has been made by or with the authority of the Head of Legal Services of Essex County Council, pursuant of section 47 of the Copyright, Designs and Patents Act 1988 ('the Act'). Unless the Act provides a relevant exception to copyright, the copy must not be copied without the prior permission of the copyright owner.

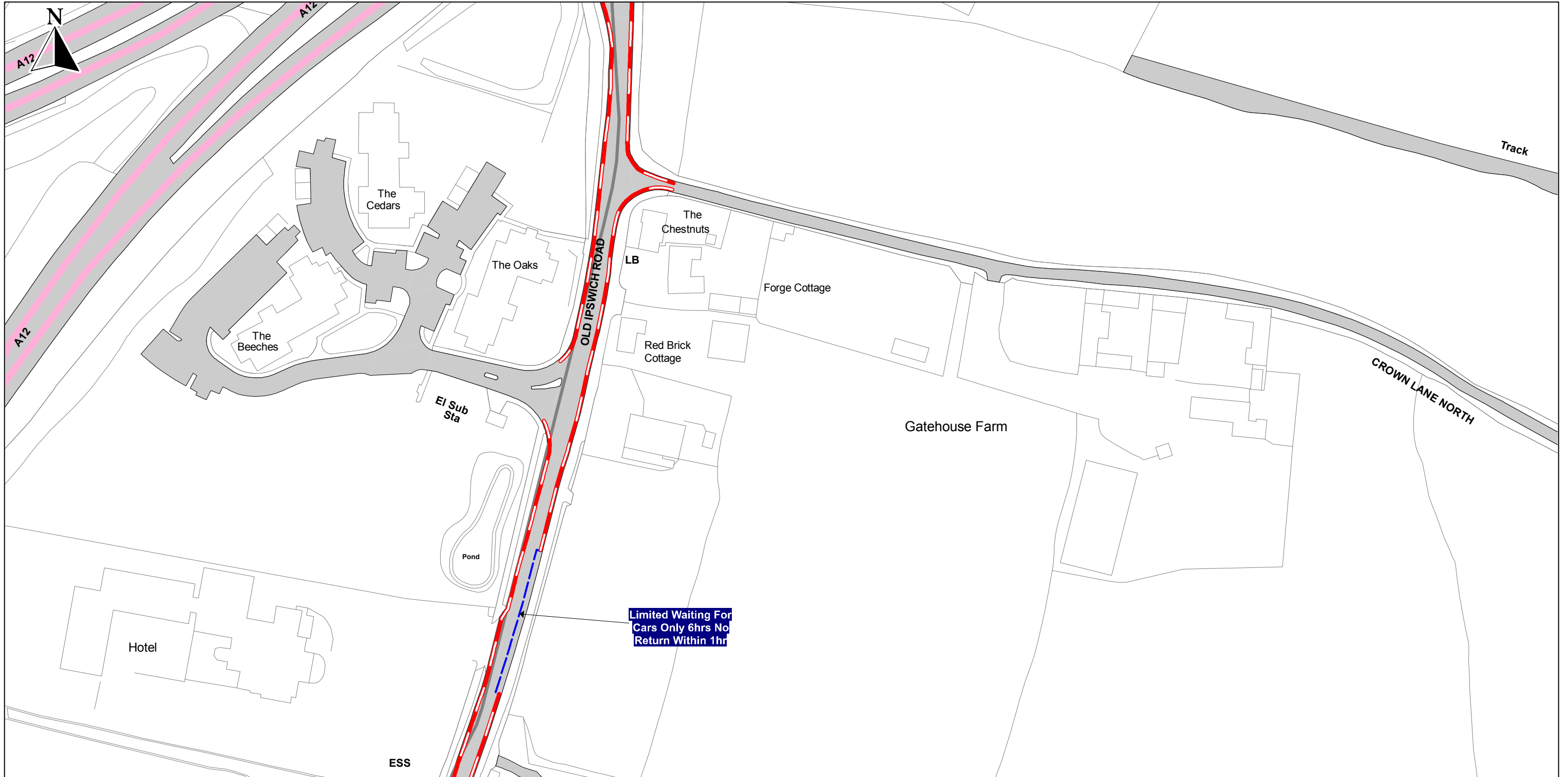

SEE STATIC MAP SCHEDULE LEGEND FOR RESTRICTIONS DISPLAYED

PROPOSED

Scale - 1 : 1250 @ A3 0 Metres 100

Title - Essex County Council On-Street Waiting, Loading and Parking Plans

Produced from Ordnance Survey 1:1250 mapping with permission of the Controller of Her Majesty's Stationary Office (c) Crown Copyright Licence No. 100019602 Unauthorised reproduction infringes Crown Copyright and may lead to prosecution or Civil Proceedings

This copy has been made by or with the authority of the Head of Legal Services of Essex County Council, pursuant of section 47 of the Copyright, Designs and Patents Act 1988 ('the Act'). Unless the Act provides a relevent exception to copyright, the copy must not be copied without the prior permission of the copyright owner.

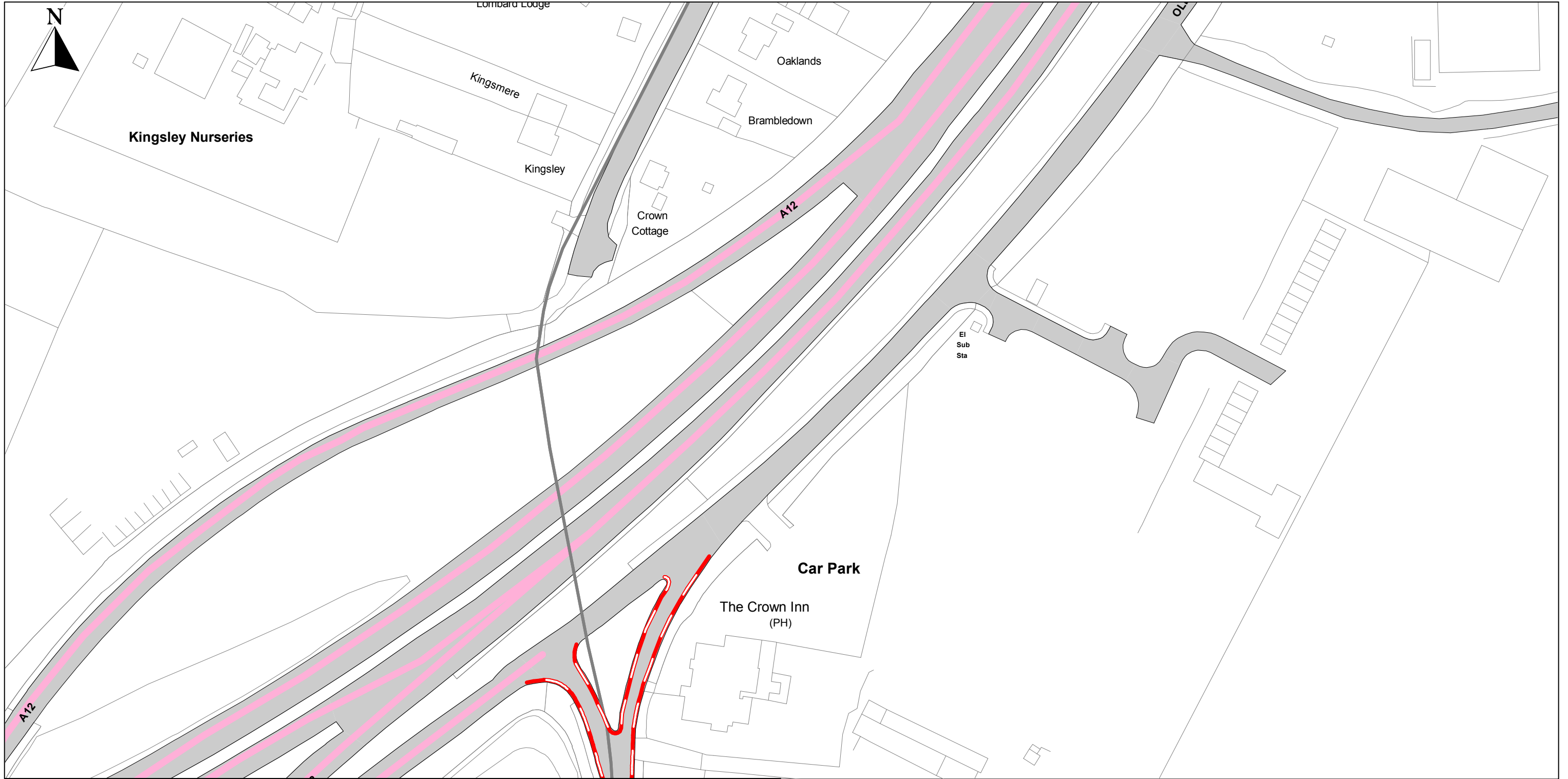

SEE STATIC MAP SCHEDULE LEGEND FOR RESTRICTIONS DISPLAYED

PROPOSED

Scale - 1 : 1250

@ A3



Title - Essex County Council On-Street Waiting, Loading and Parking Plans

Produced from Ordnance Survey 1:1250 mapping with permission of the Controller of Her Majesty's Stationary Office (c) Crown Copyright Licence No. 100019602
 Unauthorised reproduction infringes Crown Copyright and may lead to prosecution or Civil Proceedings

This copy has been made by or with the authority of the Head of Legal Services of Essex County Council, pursuant of section 47 of the Copyright, Designs and Patents Act 1988 ('the Act'). Unless the Act provides a relevant exception to copyright, the copy must not be copied without the prior permission of the copyright owner.